

HINGED FLAP SHOWN IN RAISED POSITION

#### Notes:

1. \*For Diversion Route Marker see TC2331.
2. Horizontal centre line indicates location of suitable hinge for flap.
3. Cut slots in the hinged panel and fit staples on both panels to enable padlocking of the hinged panel in both raised and lowered positions. See TC2330\_3.
4. The back of the sign is to be suitably stiffened at staple points.

#### Colour Legend

- Retroreflective white
- Retroreflective blue
- Retroreflective yellow



**Queensland  
Government**

## TRAFFIC INSTRUCTION SIGN

"ROAD CLOSED AHEAD/  
FOLLOW DIVERSION ROUTE"

Department of Transport and Main Roads  
Infrastructure Management & Delivery Division

APPROVED AS OFFICIAL TRAFFIC SIGN

Designed  
RH 06/20

Checked  
DJ 06/20

Scale  
Not to Scale

*R. King*  
PRINCIPAL ENGINEER  
(Traffic Engineering)

15/06/20  
Date

**TC2330\_1**

Page 1/3

A

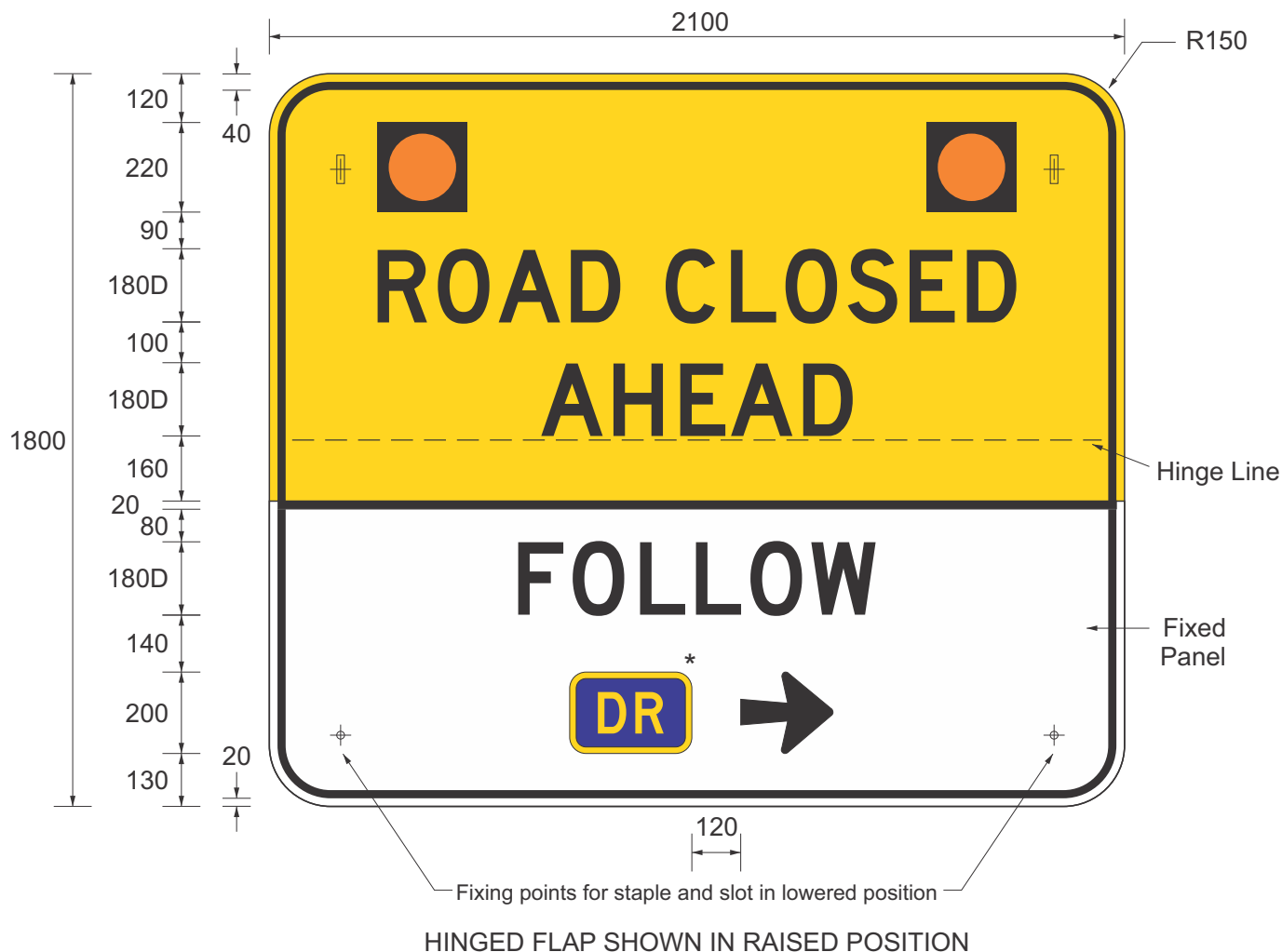

#### Notes:

1. \*For Diversion Route Marker see TC2331.
2. Horizontal centre line indicates location of suitable hinge for flap.
3. Cut slots in the hinged panel and fit staples on both panels to enable padlocking of the hinged panel in both raised and lowered positions. See TC2330\_3.
4. The back of the sign is to be suitably stiffened at staple points.

#### Colour Legend

	Retroreflective white
	Retroreflective blue
	Retroreflective yellow



**Queensland  
Government**

## TRAFFIC INSTRUCTION SIGN

"ROAD CLOSED AHEAD/FOLLOW DIVERSION  
ROUTE WITH FLASHING LIGHTS"

Department of Transport and Main Roads  
Infrastructure Management & Delivery Division

APPROVED AS OFFICIAL TRAFFIC SIGN

Designed  
RH 06/20

Checked  
DJ 06/20

Scale  
Not to Scale

PRINCIPAL ENGINEER  
(Traffic Engineering)

15/06/20  
Date

TC2330\_2

Page 2/3

A ☐ ☐ ☐ ☐

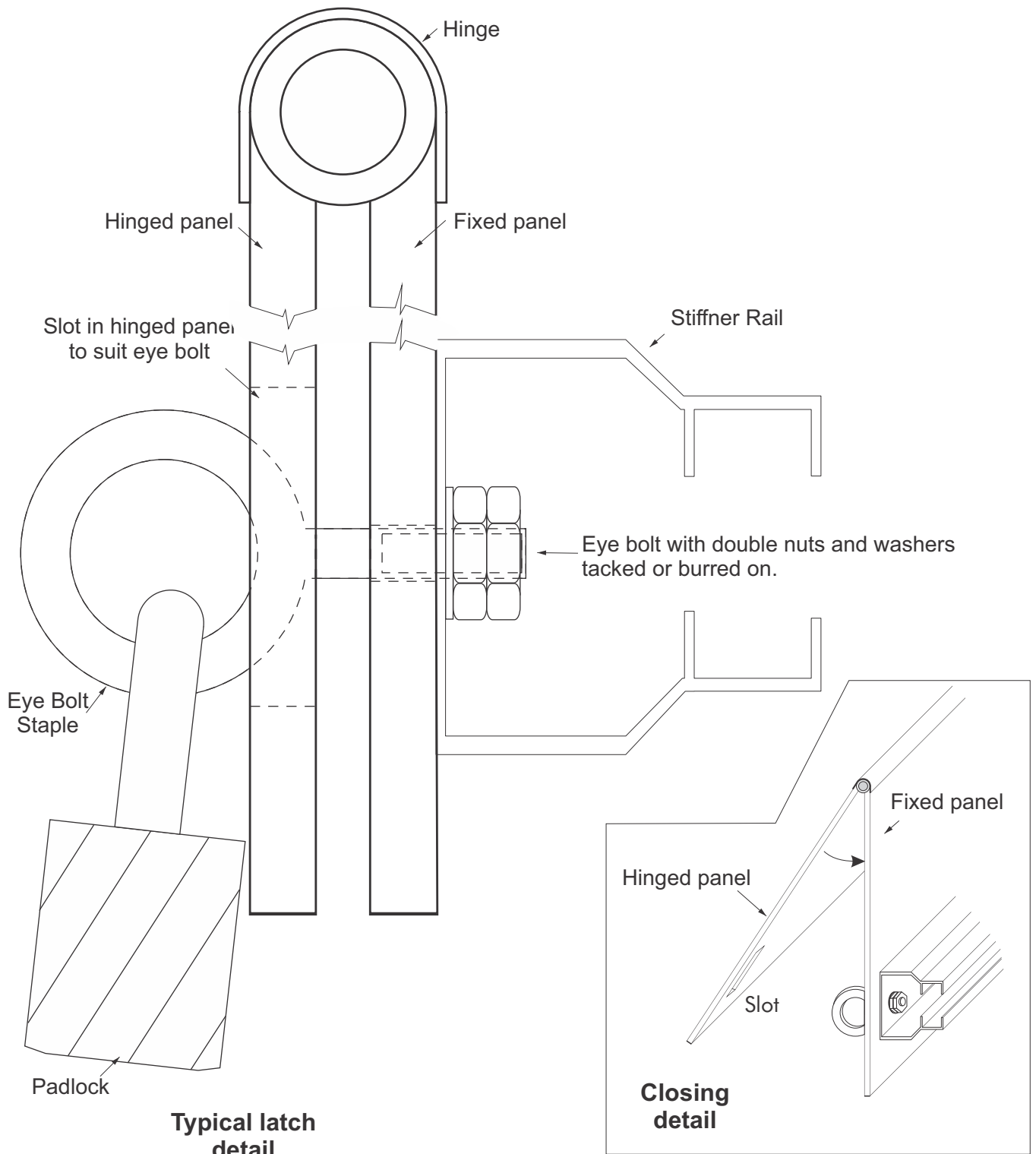

**Notes:**

1. The use of four staples are required to fasten the hinged panel in both the open and closed position.
2. Eye bolts or similar may be used as staples and should be positioned on the stiffener rails for security and strength.



**Queensland  
Government**

# TRAFFIC INSTRUCTION SIGN

## PANEL FIXING DETAILS

Department of Transport and Main Roads  
Infrastructure Management & Delivery Division

APPROVED AS OFFICIAL TRAFFIC SIGN

Designed  
RH 06/20

Checked  
DJ 06/20

Scale  
Not to Scale

*R. King*  
PRINCIPAL ENGINEER  
(Traffic Engineering)

15/06/20  
Date

**TC2330\_3**

Page 3/3

A ☐ ☐ ☐ ☐ ☐